

— IRELAND —

AIRAC

Phone: +353 (0)61 703 750
Fax: +353 (0)61 366 245
AFS: EINN ZPZX
Email: aisops@iaa.ie
URL: <https://www.iaa.ie>



Irish Aviation Authority
Aeronautical Information Service
Ballycasey Cross
Co. Clare
V14 C446
IRELAND

AIP SUP: 010/2022
Effective Date: 21-APR-2022
Publication Date: 10-MAR-2022
End Date:
Publishing Organisation: IAA

DUBLIN AIRPORT (EIDW)
CONSTRUCTION OF CRITICAL TAXIWAY NORTH PHASE 1

This Supplement is related to the changes to the aerodrome associated to the Critical Taxiway North Phase 1 construction works.

The construction work will be carried out within the aerodrome. Enabling works will have been undertaken in advance to this construction to mitigate the effect of these works on aerodrome operations.

The construction site will be set up the last week in April 2022 and the works are scheduled to take 12 months to complete.

Working hours may be varied in the course of the works but will generally be as follows:

- Day work: 0800 – 1800 (local)
- Night work: 2000 – 0400 (local)

The following taxiways will be closed during the works, and diversion routes are indicated below:

Taxiway Closed	ACFT Travelling	Diversion Route
TWY P1	LINK 5 to RWY 16/34	LINK 5>TWY F INN > Link 4> TWY M1/TWY H1 > RWY 16/34
TWY P1	RWY 16/34 to LINK 5	RWY 16/34 > TWY N > TWY K > TWY C>LINK 6> TWY F INN > LINK 5

In addition to the main works above, works required to tie into existing taxiways will be constructed during the night. The impacted taxiways will be put back into operation after each working shift. The following taxiways would be withdrawing from service during these night works:

- LINK 4
- LINK 5
- LINK 6
- TWY F INN

Dates, durations and working hours are indicative. Exact dates will be promulgated by NOTAM in due course, with reference to this Supplement.

To facilitate the tie-in of works to Runway 16/34 work will be undertaken at night (between (2000 and 0400) for a nine week period between 1/7/22 to 31/8/22) during this supplement. During this period Runway 16/34 will not be available for Take-offs / Landings or Taxiing. Exact times and dates will be promulgated by NOTAM.

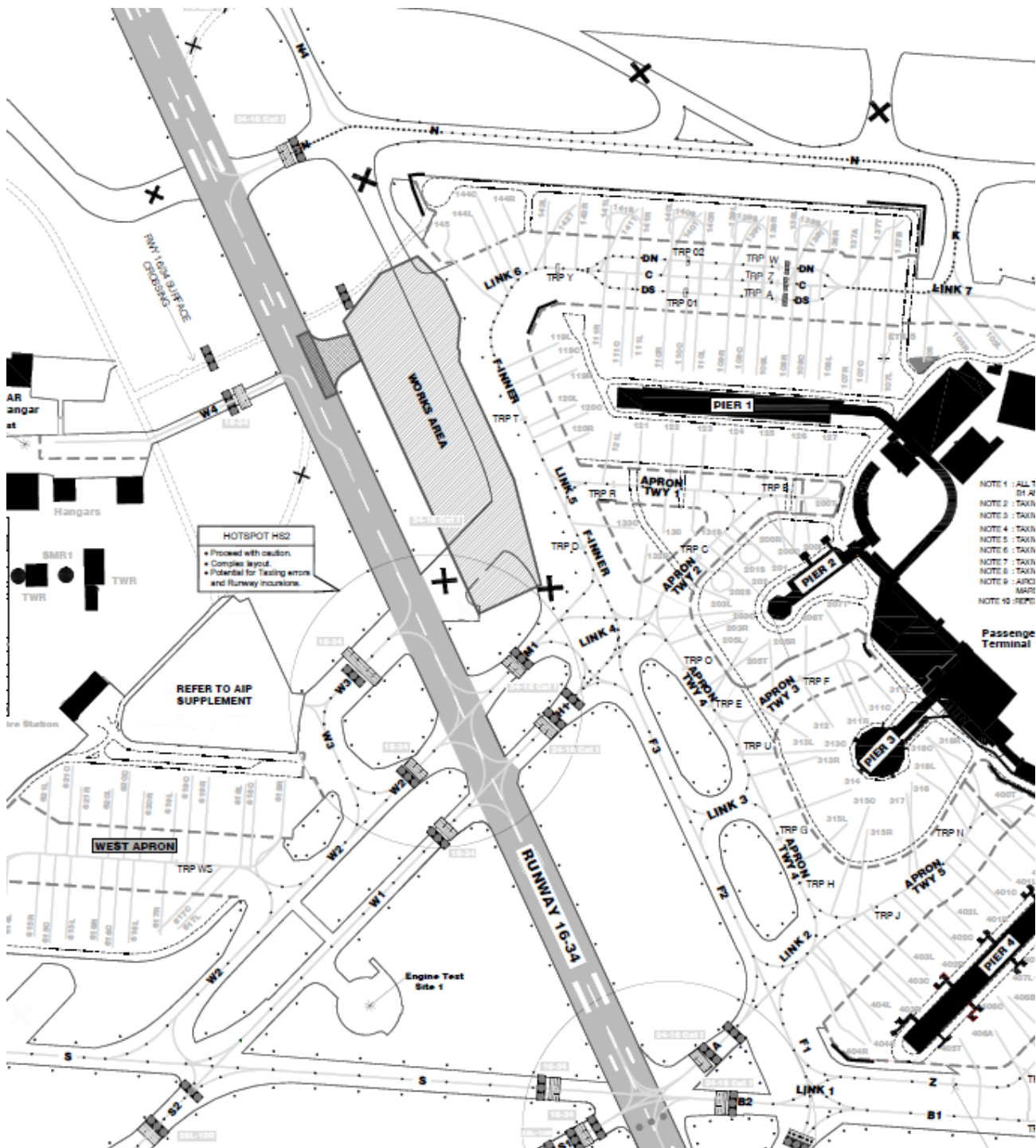

EXTRACT FROM AIP EIDW AD 2.24-2 AIRCRAFT PARKING DOCKING CHART